



LTV™ 1200 ventilator emergency set-up card

For 24-hour assistance, call 800.754.1914

For 24-hour assistance, call 800.754.1914

Step 1: Choose a power source.

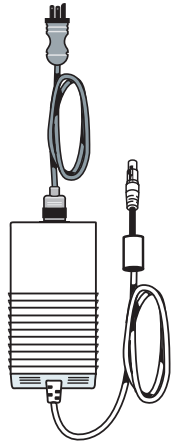

AC adapter
(Use AC power when available).

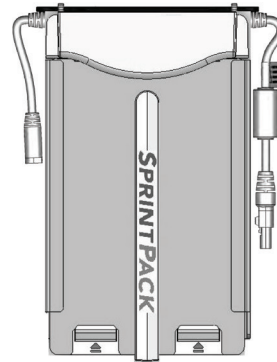

SprintPack Lithium-Ion
Power System

Step 2: Connect the LTV® 1200 ventilator to the power source.

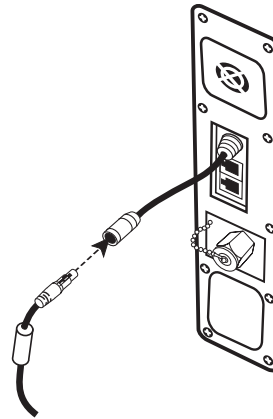
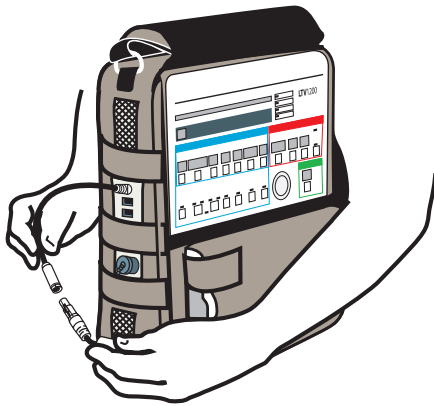

Step 3: Choose a circuit.

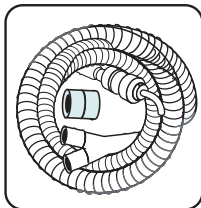

- Open bag.
- Remove patient circuit and **22 mm adapter** from bag.

Humidifier circuit (optional)



22 mm patient circuit, **adult**

>20 kg

>44 lb

22 mm adapter

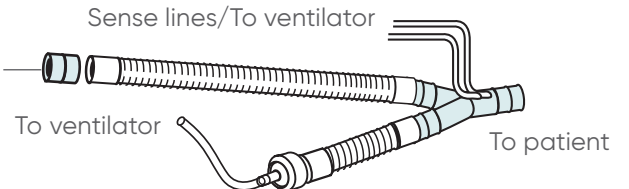

15 mm patient circuit, **infant/pediatric**

5 kg to ≤ 20 kg

11 lb ≤ 44 lb

22 mm adapter

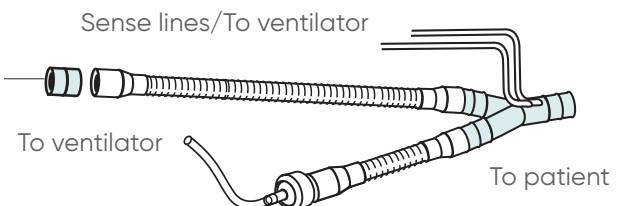

For 24-hour assistance, call 800.754.1914

Step 4: Connect the circuit to the LTV 1200 ventilator.

Filter optional

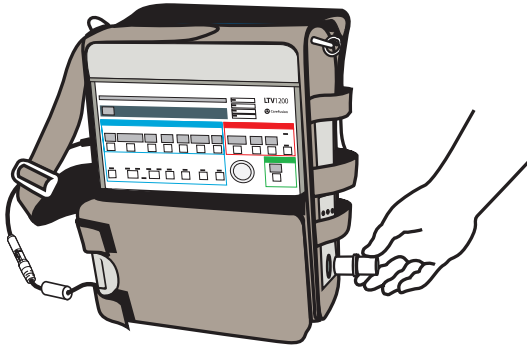

Attach 22 mm adapter
(found in circuit bag).

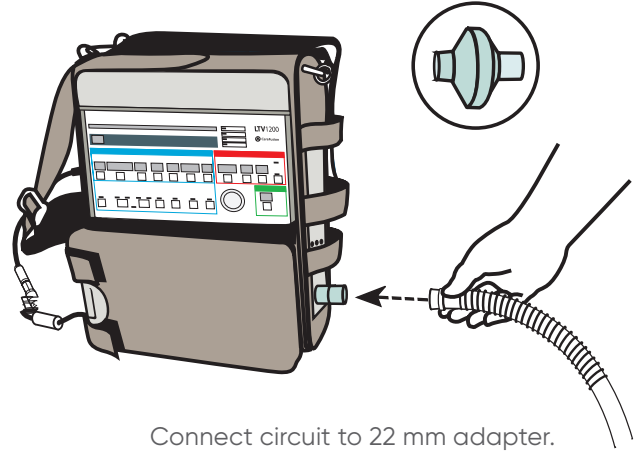

Connect circuit to 22 mm adapter.

Step 5: Connect the sense lines to the LTV 1200 ventilator.

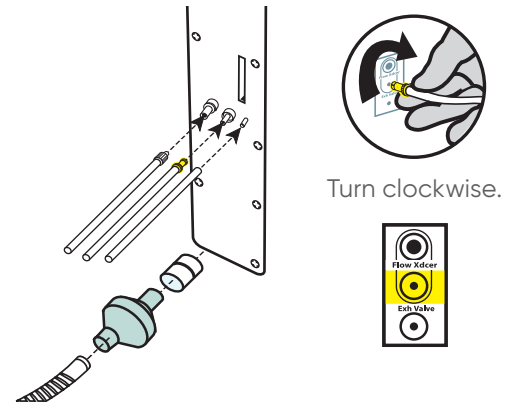
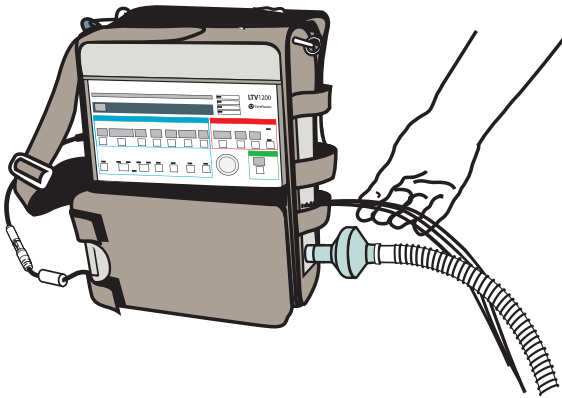

Step 6: Turn on the LTV 1200 ventilator.

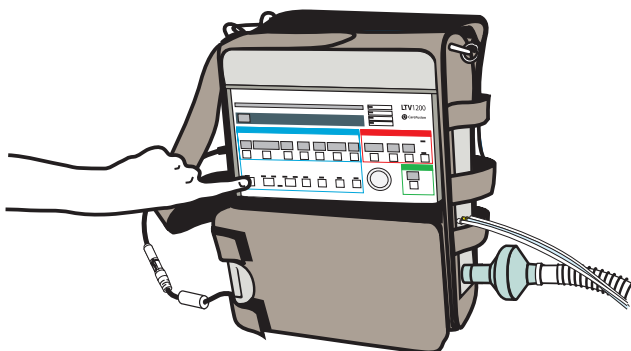

On/Standby

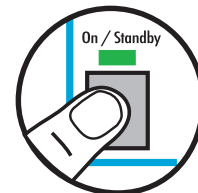
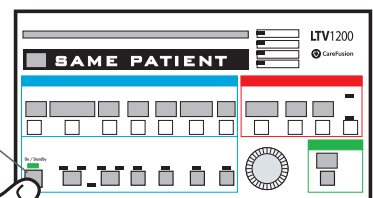

Step 7: Patient setting displays.

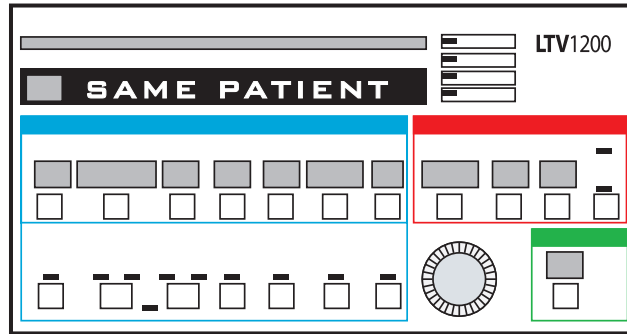

Once the power is on, see **Same Patient** display.

Step 8: Change display to the New Patient setting.

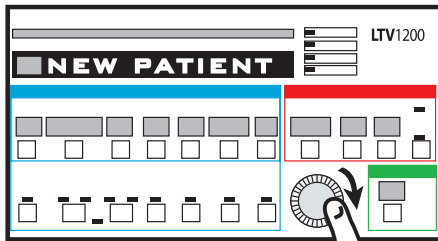

Rotate **Set Value** knob clockwise until **New Patient** is displayed.

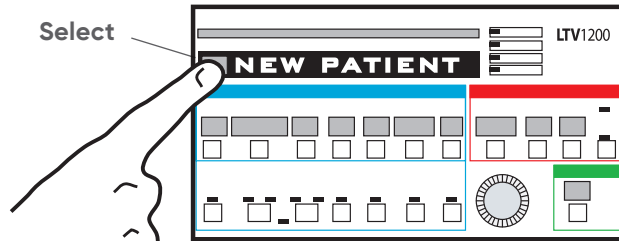

Press **Select** when **New Patient** is displayed.

Step 9: Set patient size.

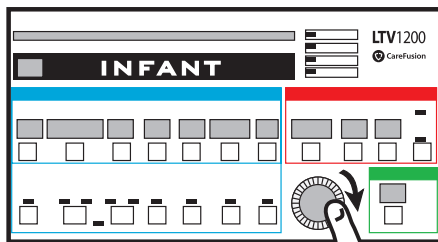

Rotate **Set Value** knob to correct patient size (*infant, pediatric or adult*).

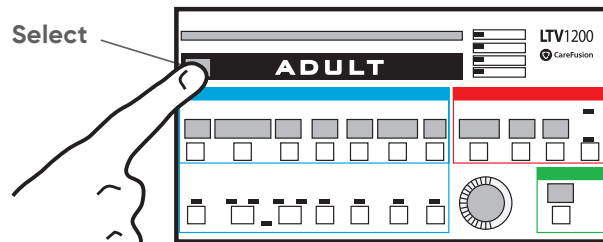

Press **Select** when proper patient size is displayed.

Note: If you make a mistake, turn the LTV 1200 ventilator off by holding the On/Standby button for three seconds. Then return to Step 6.

For 24-hour assistance, call 800.754.1914

Step 10: Connect circuit to ET tube or mask.

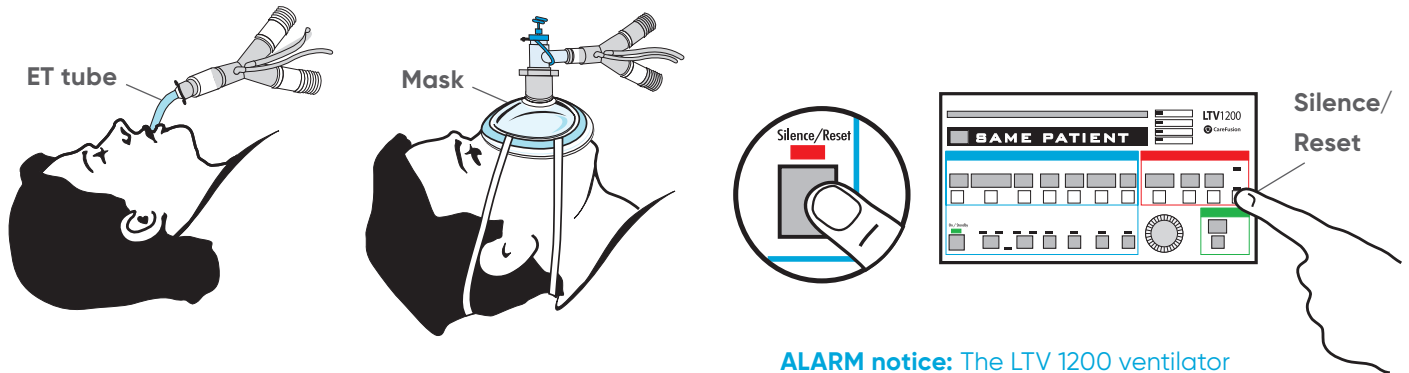

ALARM notice: The LTV 1200 ventilator will alarm until it is connected to the patient. To turn it off, you may press the **Silence/Reset** button.

Step 11: Optional: Use a mask.

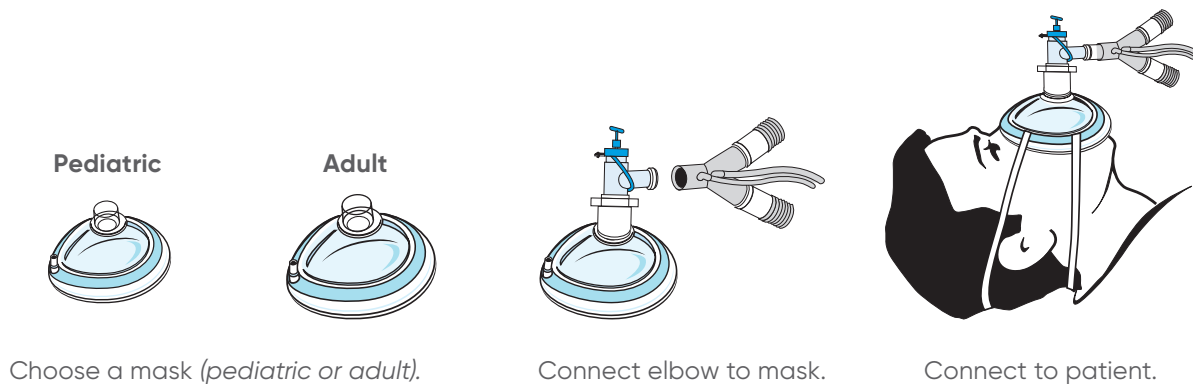

Step 12: Optional: Use an HME and/or flextube as shown for patient comfort.

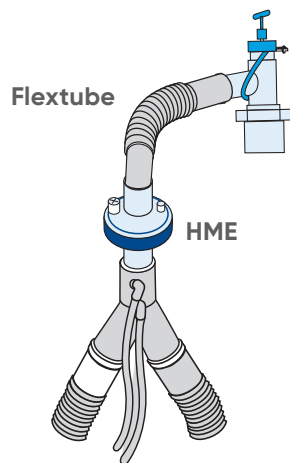

This emergency set-up card is intended to provide emergency instructions for initial LTV 1200 ventilator set-up. The initial settings may need to be adjusted based on the patient's clinical condition. For complete information regarding set-up and operation, refer to the LTV 1200 ventilator operator's manual.

GLOBAL
HEADQUARTERS

Vyaire Medical, Inc.
26125 North Riverwoods Blvd
Mettawa, IL 60045
USA

vyaire.com

 **For global distribution.**

©2020 Vyaire. Vyaire, the Vyaire logo and all other trademarks or registered trademarks are property of Vyaire Medical, Inc., or one of its affiliates. Please read the complete Instructions For Use that come with the devices or follow the instructions on the product labelling. VYR-GBL-2000138